

**HANDSETS:**

S10-063-00100:  
FOR PWCPP003  
WITH KEY IGNITION

S10-063-00200:  
FOR PWCPP010  
WITH FWD/REV  
BUTTON

**BATTERIES AND PACKS:**

S17-063-00100:  
PACK (NO LOGO) WITH BATTERY

S17-063-00200:  
PACK (NO LOGO) NO BATTERY

S17-063-00400:  
PACK (DRIVE LOGO) NO BATTERY

12V17AH:  
REPLACEMENT BATTERY ONLY

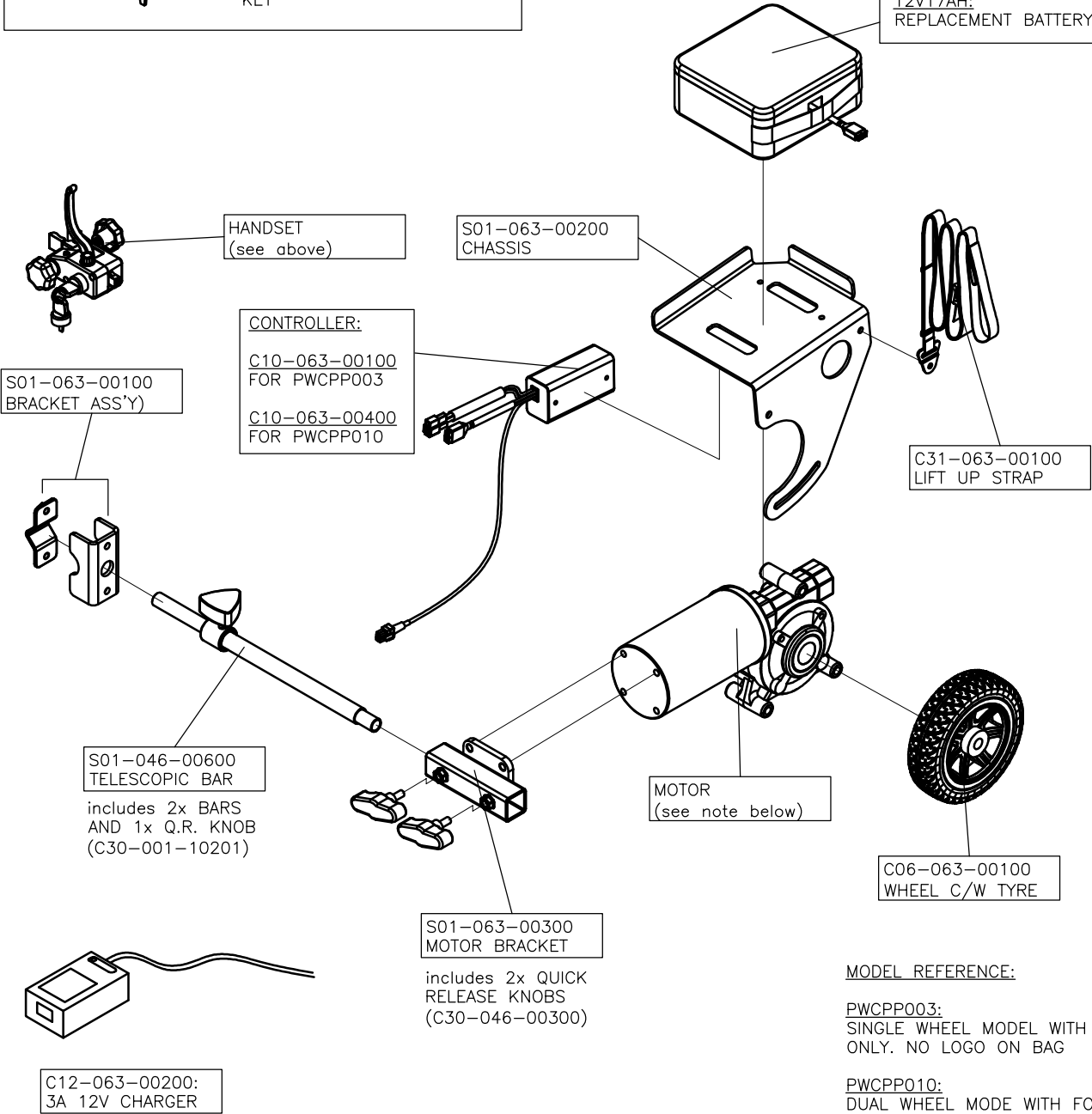

**MODEL REFERENCE:**

PWCPP003:  
SINGLE WHEEL MODEL WITH FORWARD ONLY. NO LOGO ON BAG

PWCPP010:  
DUAL WHEEL MODE WITH FORWARD AND REVERSE. DRIVE LOGO ON BAG

**OPTIONAL EXTRAS:**

- C38-046-00100 : CARRY BAG

**MOTOR AND GEARBOX PARTS AVAILABLE:**

C09-063-00200 : GEAR BOX  
C09-063-00300 : 100W 12V MOTOR  
C09-005-00601 : 7x11mm MOTOR BRUSH

| REV No. | DETAILS                     | DATE    | DRAWN |
|---------|-----------------------------|---------|-------|
| A       | IN THE ORIGINAL DESIGN      | 24/1/12 | PMK   |
| B       | PROVIDE THE USER WITH A BAG | 8/5/13  | PMK   |
| C       | COLOR THE BAG               | 31/1/14 | PMK   |